



Electro Mechanical Systems



**NORSTAT INC.**

300 Roundhill Drive Unit 4  
Rockaway, NJ 07866 Tel:  
973-586-2500  
[www.norstat.com](http://www.norstat.com)

## OUR WORK

EMS is an electromechanical company serving the elevator, escalator and automation sectors. *Experience, dynamism, quality, flexibility and service are the keys to our success.*

Though being a newly born company, the EMS team is characterized by people who have worked over 40 years in the elevator/escalator field.

We have organized a production unit in Asia which operates under our direct quality control, using our experienced know how, to meet global certifications and rules.

EMS is an innovative company structured to be slim and very flexible, adapting to the needs of the market.

Service is the first thing in our business because we assist the customer from product development to the delivery and after sales.

For us the customer is not a “number” but a person with his/her requirements and with his/her specific needs which are our primary target to serve.

## OUR PRODUCT

Thanks to our R&D department, we are able to bring both standard and fully customised solutions. The design and development of prototypes is completely achieved within Europe. Once the prototype fully satisfies the customer, production begins. Our goal is to create synergy with the customer so that he/she feels unique and confident. The development of our products is also viewed by expert engineers working in direct contact with the most famous Italian and Spanish universities, and this always allows us to adopt updated and innovative solutions.

## CERTIFICATIONS

To make our projects transparent, we have adopted the most advanced technologies in both primary materials and applied electronics. We have obtained major certifications such as CE, UL/CSA and others, recognising the importance of this to our customers. For this reason our products are not the result of any adaptation to certification, but our innovative and uniquely developed to the needs of our clients.



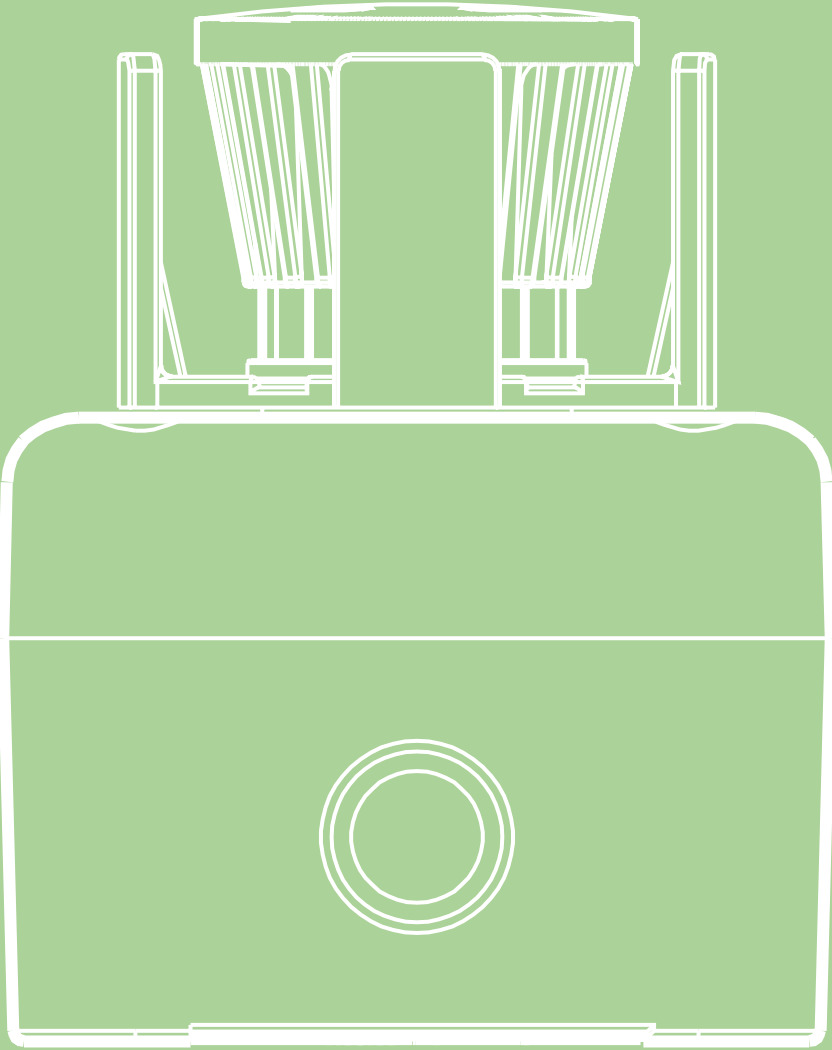

1 HOLE EMERGENCY STATION



MONOLITHIC EMERGENCY MUSHROOMS

TWIST TO RELEASE

CONTACTS CONFIGURATION	PART NUMBER
1NC	1NC — B1MA001
1NC+1NO	1NC+1NO — B1MA002
2NC	2NC — B1MA003

DIMENSIONS

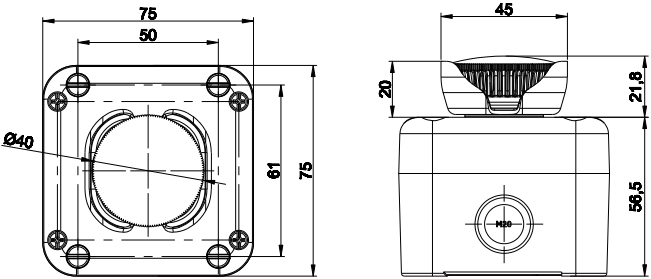

PUSH-PULL

CONTACTS CONFIGURATION	PART NUMBER
1NC	1NC — B1MA004
1NC+1NO	1NC+1NO — B1MA005
2NC	2NC — B1MA006

DIMENSIONS

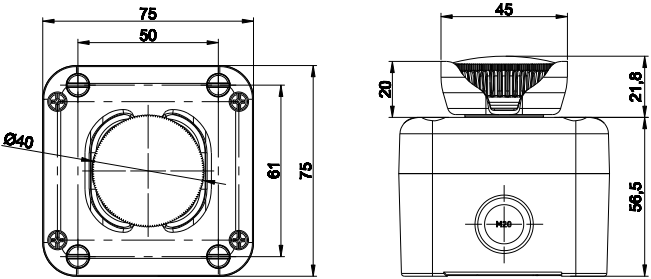

MODULAR EMERGENCY MUSHROOM  
WITH CONTACTS



TWIST TO RELEASE			
CONTACTS CONFIGURATION		PART NUMBER	
1NC	1NC+1NO	2NC	
1NC	1NC+1NO	2NC	
—	—	—	
B10A001	B10A002	B10A003	

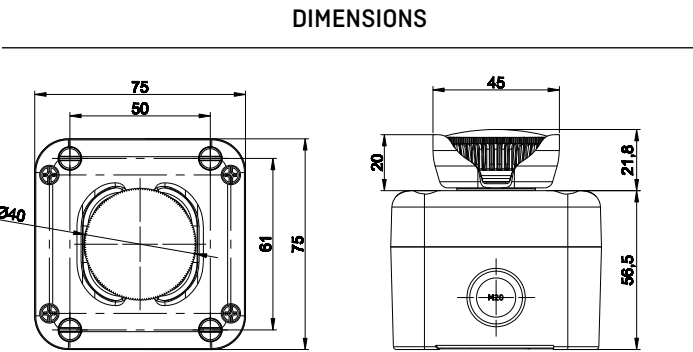

TWIST TO RELEASE VISION			
CONTACTS CONFIGURATION		PART NUMBER	
1NC	1NC+1NO	2NC	
1NC	1NC+1NO	2NC	
—	—	—	
B10A007	B10A008	B10A009	

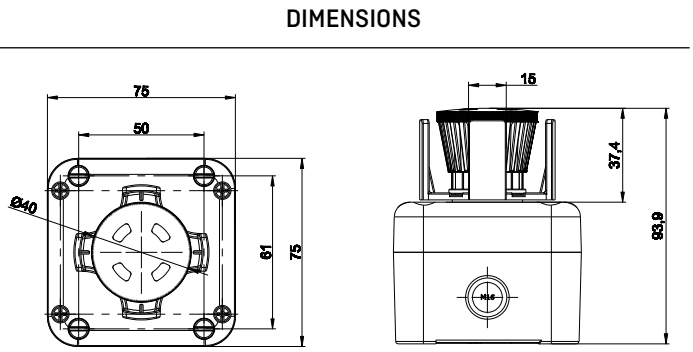

PUSH-PULL			
CONTACTS CONFIGURATION		PART NUMBER	
1NC	1NC+1NO	2NC	
1NC	1NC+1NO	2NC	
—	—	—	
B10A004	B10A005	B10A006	

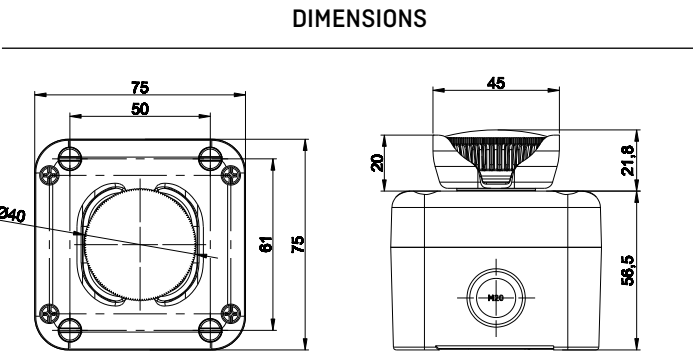

PUSH-PULL VISION			
CONTACTS CONFIGURATION		PART NUMBER	
1NC	1NC+1NO	2NC	
1NC	1NC+1NO	2NC	
—	—	—	
B10A010	B10A011	B10A012	

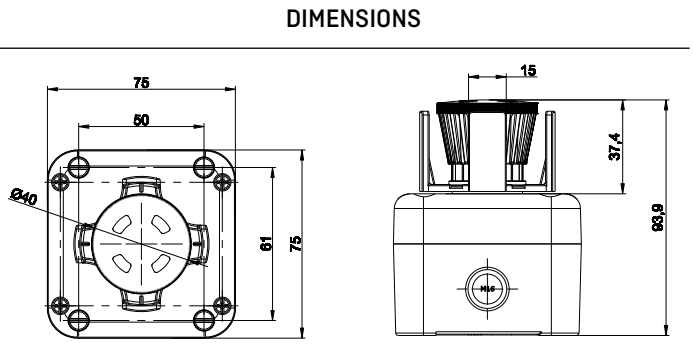

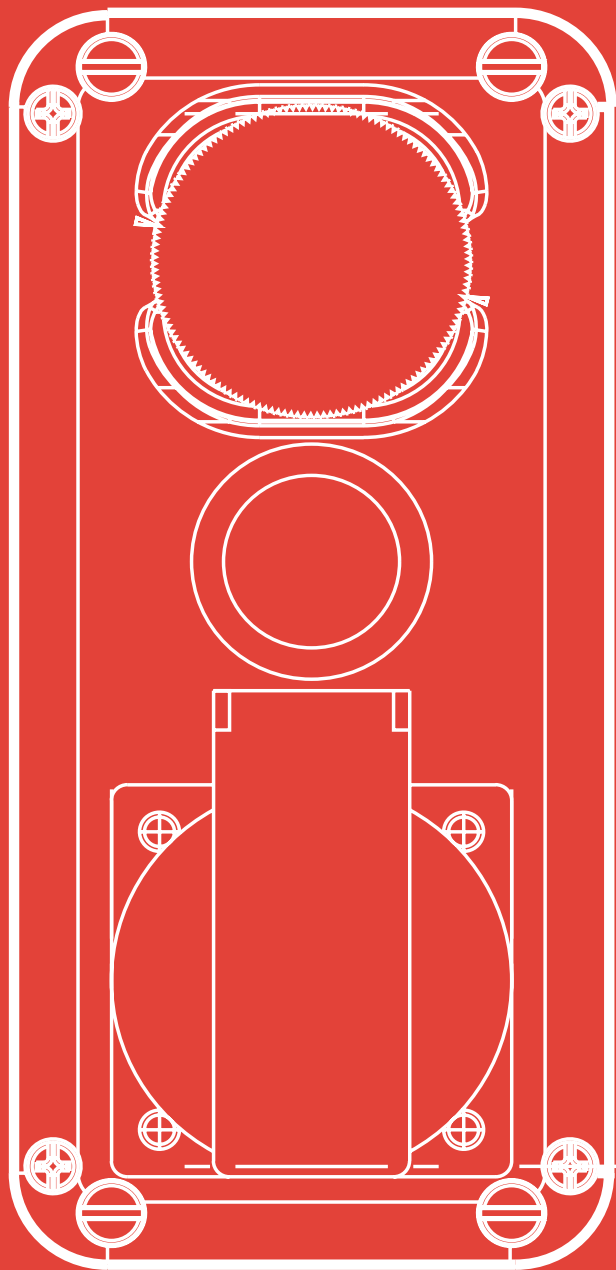





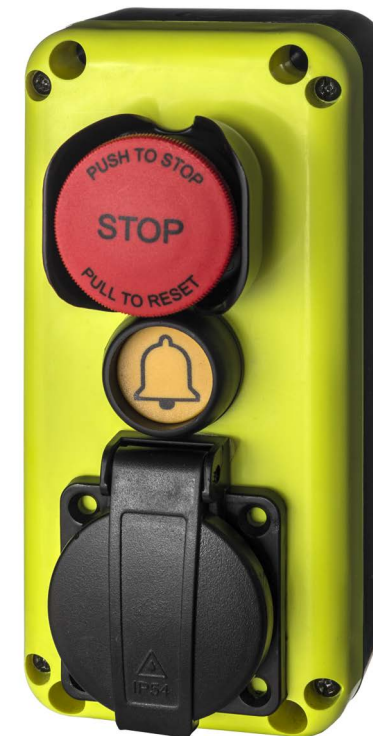



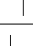

3 HOLE EMERGENCY STATION

MONOLITHIC E-STOP, LIGHT, ALARM, SOCKET

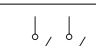

PUSH PULL + ALARM + SOCKET			
E-STOP	ALARM	SOCKET	PART NUMBER
1NC 	2NO 	UNIVERSAL	B3MC001
1NC+1NO 	1NC+1NO 	UNIVERSAL	B3MC002
2NC 	2NO 	UNIVERSAL	B3MC003
1NC 	2NO 	SCHUKO	B3MC004
1NC+1NO 	1NC+1NO 	SCHUKO	B3MC005
2NC 	2NO 	SCHUKO	B3MC006

DIMENSIONS

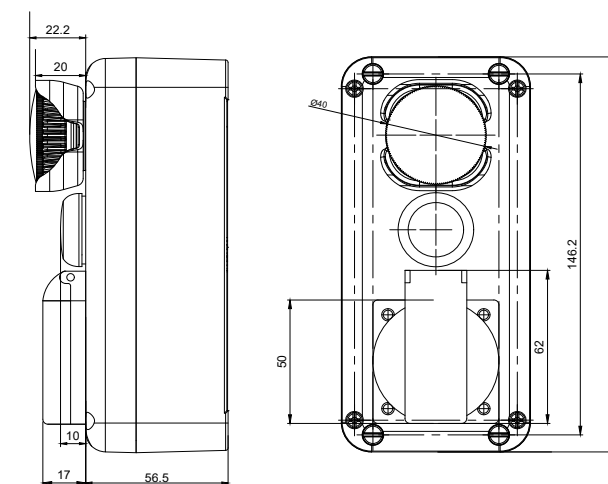





MONOLITHIC E-STOP TWIST TO RELEASE + LIGHT + SOCKET

E-STOP		LIGHT		SOCKET	PART NUMBER
1NC		2NO		UNIVERSAL	B3MC007
1NC+1NO		1NC+1NO		UNIVERSAL	B3MC008
2NC		2NO		UNIVERSAL	B3MC009
1NC		2NO		SCHUKO	B3MC010
1NC+1NO		1NC+1NO		SCHUKO	B3MC011
2NC		2NO		SCHUKO	B3MC012

DIMENSIONS

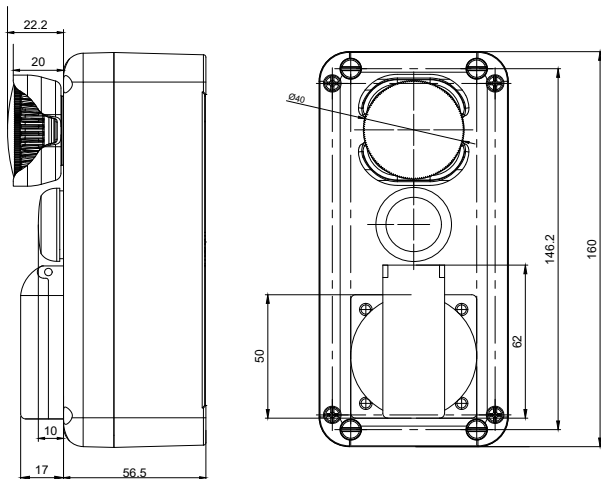

MONOLITHIC E-STOP PUSH PULL + ALARM-LIGHT + SOCKET

E-STOP		ALARM		LIGHT		SOCKET	PART NUMBER
1NC		1NO		1NO		UNIVERSAL	B3MOC007
2NC		1NO		1NO		UNIVERSAL	B3MOC008
1NC		1NO		1NO		SCHUKO	B3MOC009
2NC		1NO		1NO		SCHUKO	B3MOC010

DIMENSIONS

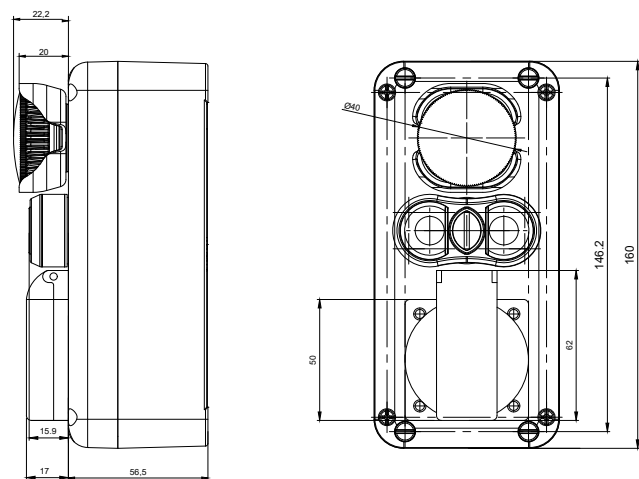

MODULAR E-STOP, LIGHT, SOCKET

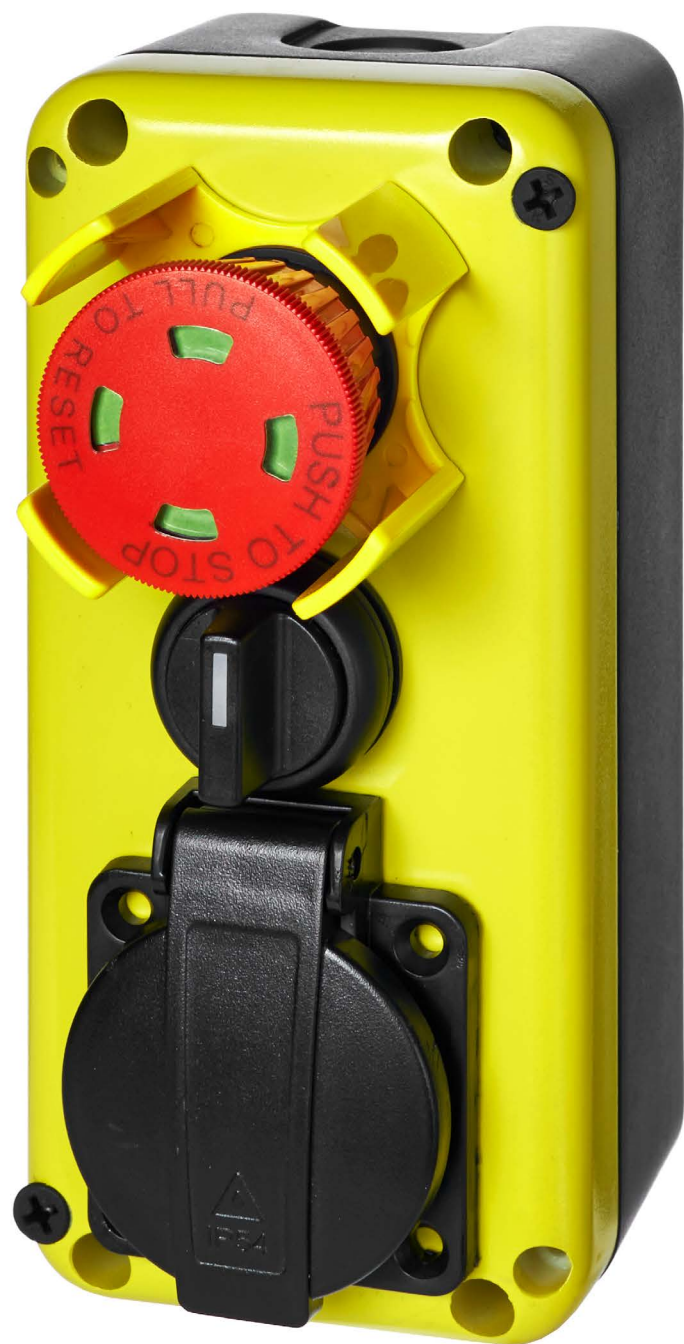

E-STOP VISION PUSH PULL + LIGHT SWITCH + SOCKET

E-STOP	LIGHT SWITCH	SOCKET	PART NUMBER
1NC	1NO	UNIVERSAL	B3M0C001
2NC	1NO	UNIVERSAL	B3M0C002
1NC+1NO	1NC+1NO	UNIVERSAL	B3M0C003
1NC	1NO	SCHUKO	B3M0C004
2NC	1NO	SCHUKO	B3M0C005
1NC+1NO	1NC+1NO	SCHUKO	B3M0C006

DIMENSIONS

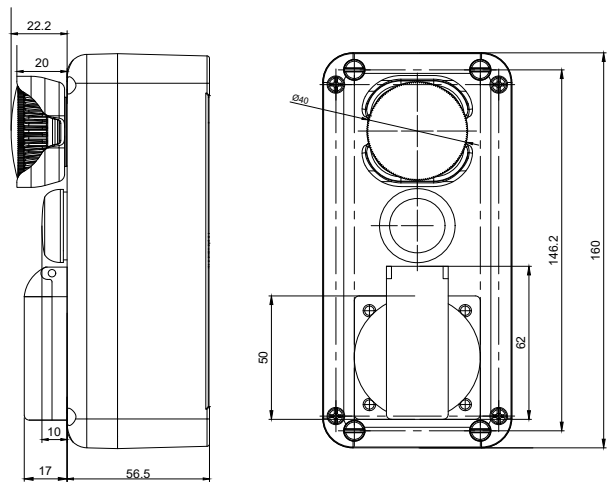

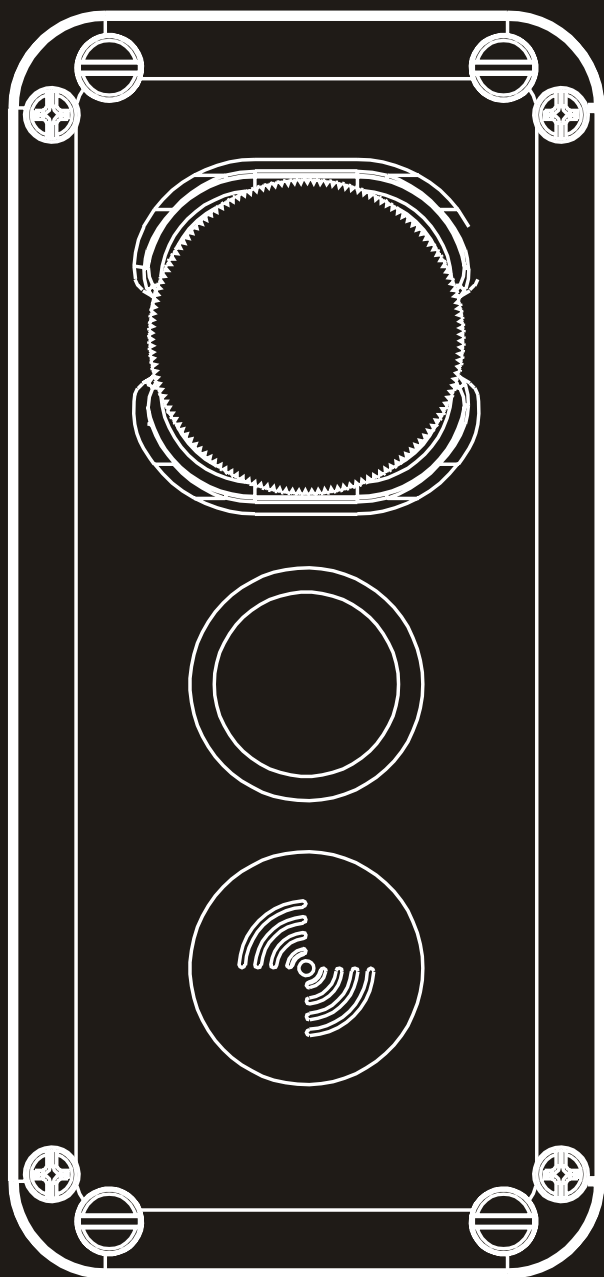

## EMERGENCY LIGHT STATIONS



MONOLITHIC E-STOP TWIST TO RELEASE  
+ YELLOW INTERMITTENT LED 10 LUMEN + BUZZER

E-STOP		LED	BUZZER	PART NUMBER
1NC		24 V AC/DC	24 V AC/DC	B3MA001
1NC		240 V AC	240 V AC	B3MA002
2NC		24 V AC/DC	24 V AC/DC	B3MA003
2NC		240 V AC	240 V AC	B3MA004

### DIMENSIONS

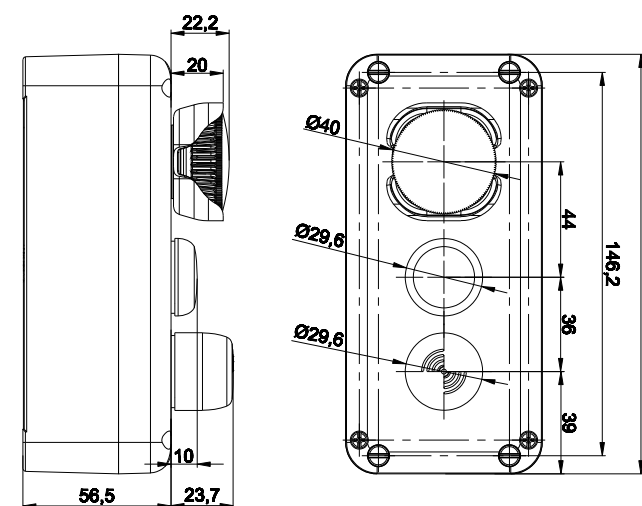





MONOLITHIC E-STOP TWIST TO RELEASE  
+ WHITE POWER LED 20 LUMEN + BUZZER

E-STOP		LED	BUZZER	PART NUMBER
1NC		24 V AC/DC	24 V AC/DC	B3MA005
1NC		240 V AC	240 V AC	B3MA006
2NC		24 V AC/DC	24 V AC/DC	B3MA007
2NC		240 V AC	240 V AC	B3MA008

DIMENSIONS

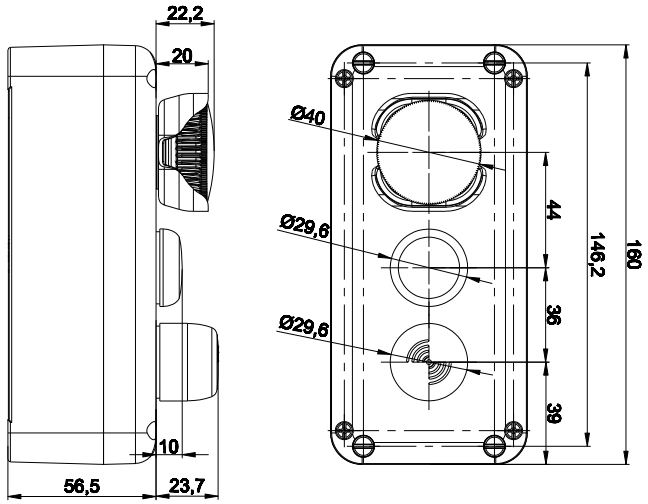

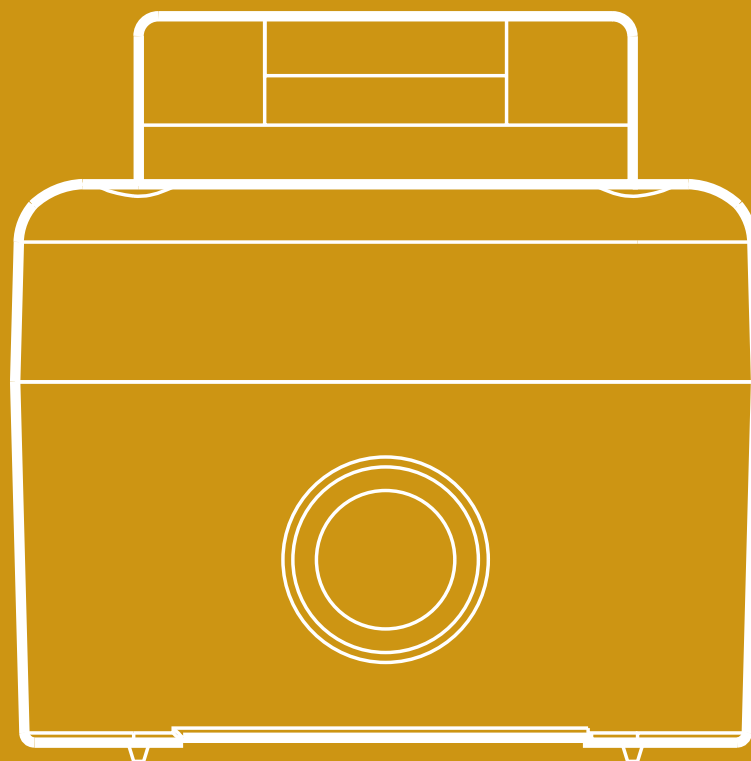





PIT BOTTOM STATIONS



POWER SOCKET



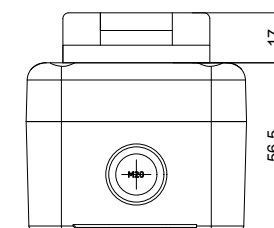
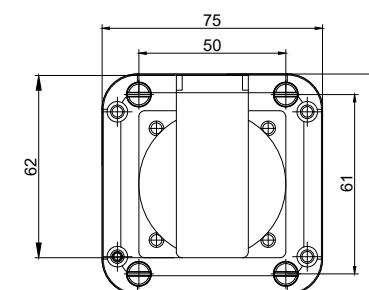

SOCKET	PART NUMBER		
UNIVERSAL	B1C001		Schuko
			Cenelec
			Swiss
SCHUKO	B1C002		USA
			BS

DIMENSIONS







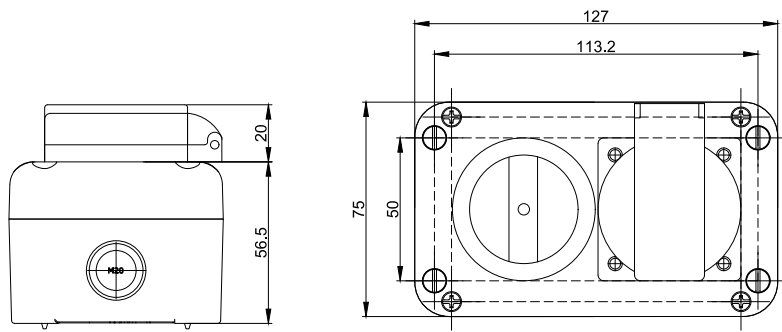

SOCKET+LIGHT SWITCH

SOCKET	PART NUMBER		
UNIVERSAL	B2C001		Schuko
			Cenelec
			Swiss
SCHUKO	B2C002		USA
			BS
DIMENSIONS			

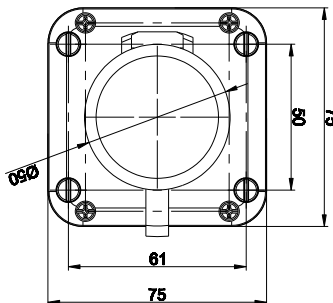

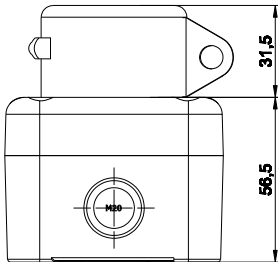
BYPASS SWITCH STATION

BY-PASS SWITCH SCHEME	PART NUMBER	DIMENSIONS																																			
<div>1</div> <div><table><tr><td></td><td>1</td><td>3</td><td>5</td><td>7</td></tr><tr><td>1</td><td>X</td><td></td><td>X</td><td></td></tr><tr><td>0</td><td></td><td></td><td></td><td></td></tr><tr><td>2</td><td></td><td>X</td><td></td><td>X</td></tr></table></div>		1	3	5	7	1	X		X		0					2		X		X	B10B001																
	1	3	5	7																																	
1	X		X																																		
0																																					
2		X		X																																	
<div>2</div> <div><table><tr><td></td><td>1</td><td>3</td><td>5</td><td>7</td><td>9</td><td>11</td></tr><tr><td>1</td><td>X</td><td></td><td>X</td><td></td><td>X</td><td></td></tr><tr><td>0</td><td></td><td></td><td></td><td></td><td></td><td></td></tr><tr><td>2</td><td></td><td>X</td><td></td><td>X</td><td></td><td>X</td></tr><tr><td>3</td><td></td><td></td><td></td><td></td><td>X</td><td></td></tr></table></div>		1	3	5	7	9	11	1	X		X		X		0							2		X		X		X	3					X		B10B002	
	1	3	5	7	9	11																															
1	X		X		X																																
0																																					
2		X		X		X																															
3					X																																
<div>3</div> <div><table><tr><td></td><td>1</td><td>3</td><td>5</td><td>7</td></tr><tr><td>1</td><td>X</td><td></td><td></td><td>X</td></tr><tr><td>0</td><td></td><td></td><td></td><td></td></tr><tr><td>2</td><td></td><td>X</td><td></td><td>X</td></tr><tr><td>3</td><td></td><td></td><td>X</td><td>X</td></tr></table></div>		1	3	5	7	1	X			X	0					2		X		X	3			X	X	B10B003											
	1	3	5	7																																	
1	X			X																																	
0																																					
2		X		X																																	
3			X	X																																	
<div>4</div> <div><table><tr><td></td><td>1</td><td>3</td><td>5</td><td>7</td></tr><tr><td>1</td><td>X</td><td></td><td></td><td></td></tr><tr><td>0</td><td></td><td></td><td></td><td></td></tr><tr><td>2</td><td></td><td></td><td>X</td><td></td></tr><tr><td>3</td><td></td><td></td><td></td><td>X</td></tr></table></div>		1	3	5	7	1	X				0					2			X		3				X	B10B004											
	1	3	5	7																																	
1	X																																				
0																																					
2			X																																		
3				X																																	

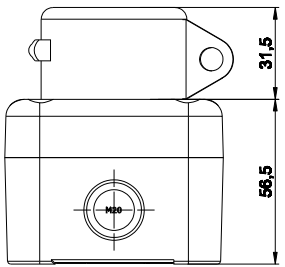

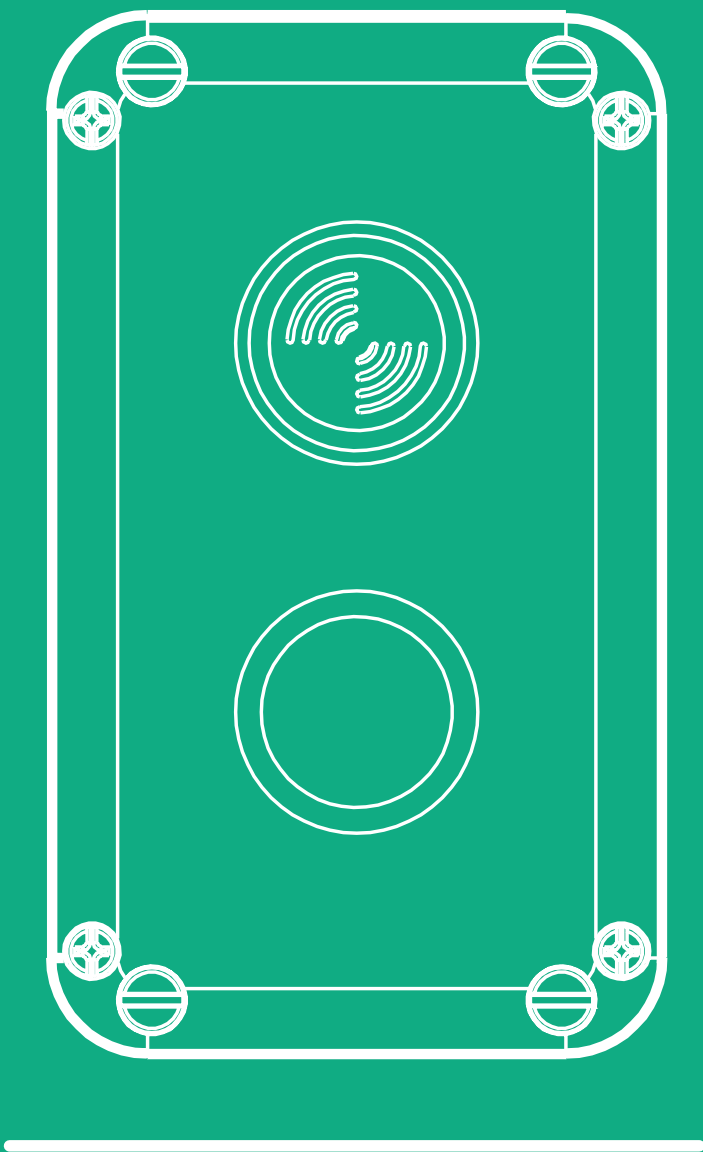

PIT BOTTOM LIGHT STATIONS



INTERMITTENT LED 10 LUMEN

LED COLOUR	POWER	PART NUMBER
YELLOW	24 V AC/DC	B1MA008
YELLOW	240 V AC	B1MA009

DIMENSIONS

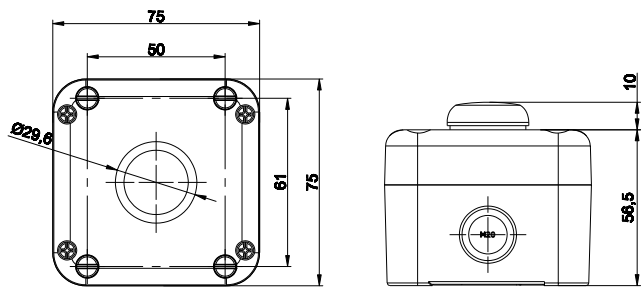

POWER LED 20 LUMEN

LED COLOUR	POWER	PART NUMBER
WHITE	24 V AC/DC	B1MA010
WHITE	240 V AC	B1MA011

DIMENSIONS

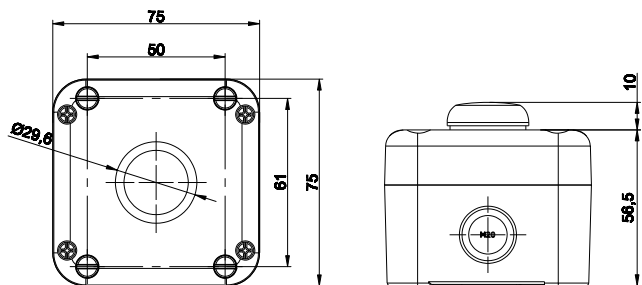



BUZZER + INTERMITTENT LED LIGHT 10 LUMEN

LED COLOUR	BUZZER	POWER	PART NUMBER
YELLOW	BLACK	24 V AC/DC	B2MA001
YELLOW	BLACK	240 V AC	B2MA002

DIMENSIONS

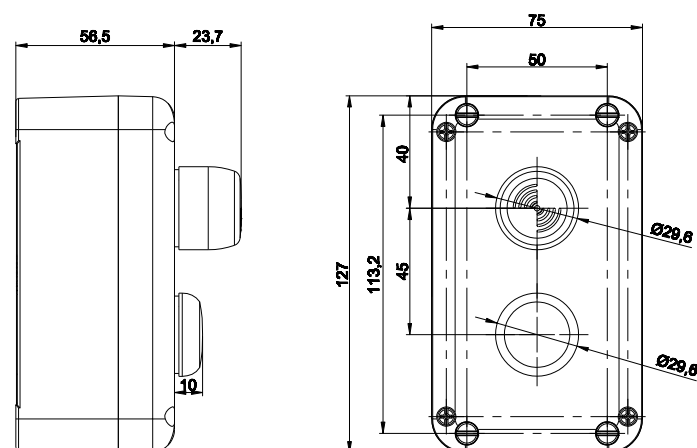

BUZZER + POWER LED LIGHT 20 LUMEN



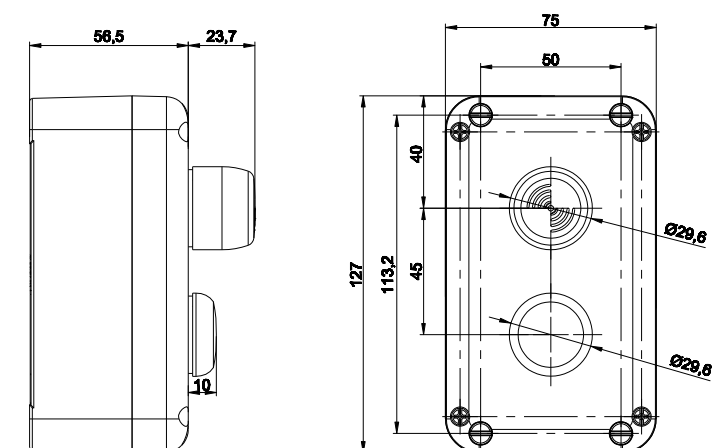

LED COLOUR	BUZZER	POWER	PART NUMBER
WHITE	BLACK	24 V AC/DC	B1MA003
WHITE	BLACK	240 V AC	B1MA004

DIMENSIONS





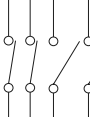

MONOLITHIC E-STOP PUSH PULL + UP-DOWN + COMMON + NORMAL INSPECTION SWITCH					
E-STOP	UP	DOWN	COMMON	SWITCH	PART NUMBER
 1NC	 1NO	 1NO	 1NC+1NO	 2NC+2NO	B4MA001

E-STOP PUSH PULL + UP-DOWN + COMMON + NORMAL INSPECTION SWITCH

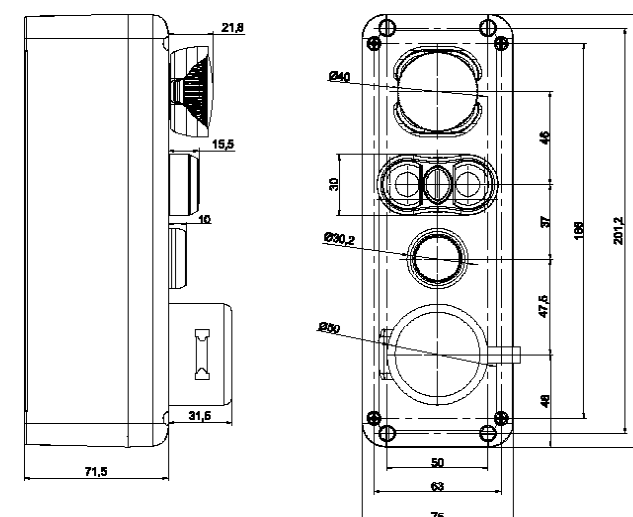



MONOLITHIC E-STOP PUSH PULL + UP-DOWN + ALARM-COMMON + NORMAL INSPECTION SWITCH

E-STOP	UP	DOWN	COMMON	SWITCH	PART NUMBER
1NC	1NO	1NO	1NO	2NC+2NO	B4MA002

DIMENSIONS

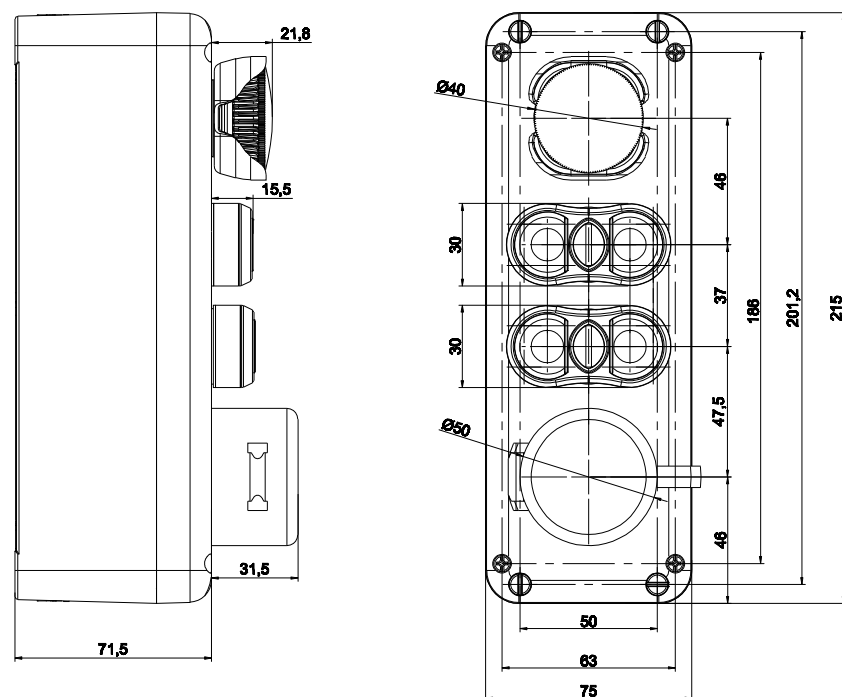

MONOLITHIC E-STOP PUSH PULL + UP + DOWN + NORMAL INSPECTION SWITCH

E-STOP	UP	DOWN	SWITCH	PART NUMBER
2NC	2NO	2NO	3NC+1NO	B4MA003

DIMENSIONS

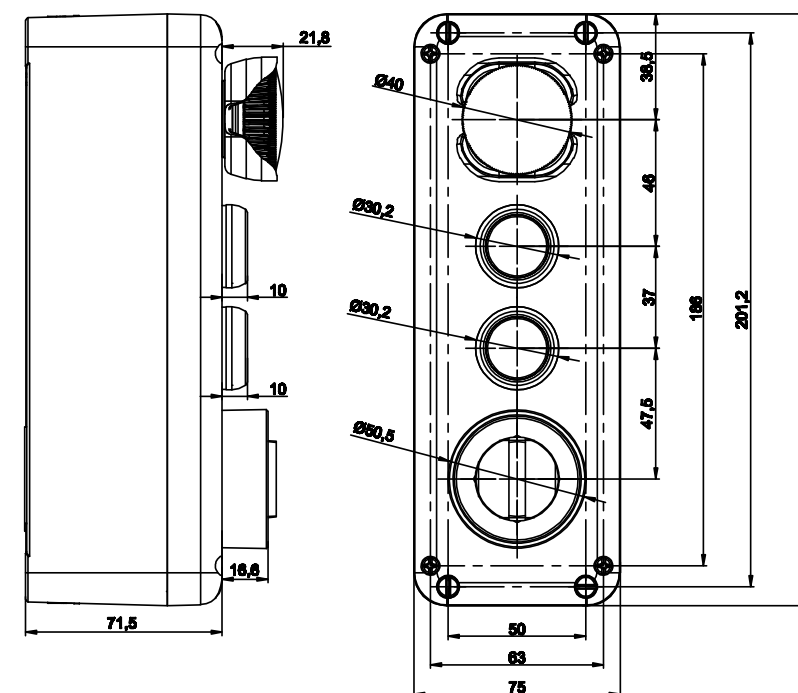



MONOLITHIC E-STOP PUSH PULL + NORMAL INSPECTION SWITCH + UP + COMMON + DOWN

E-STOP	SWITCH	UP	COMMON	DOWN	PART NUMBER
2NC	3NC+1NO	2NO	1NC+1NO	2NO	B5MA001

DIMENSIONS

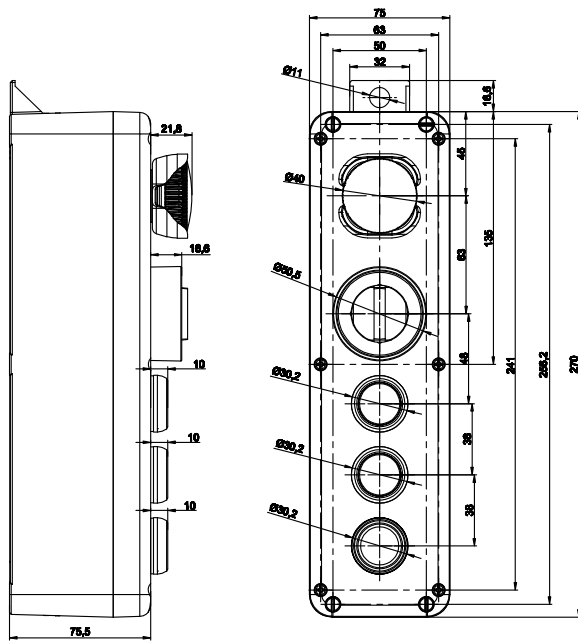

MONOLITHIC E-STOP PUSH PULL + NORMAL INSPECTION SWITCH + UP + COMMON + DOWN

E-STOP	SWITCH	UP	DOWN	COMMON	LED INT	PART NUMBER
2NC	3NC+1NO	2NO	2NO	1NO	10 lumen	B5MA002

DIMENSIONS

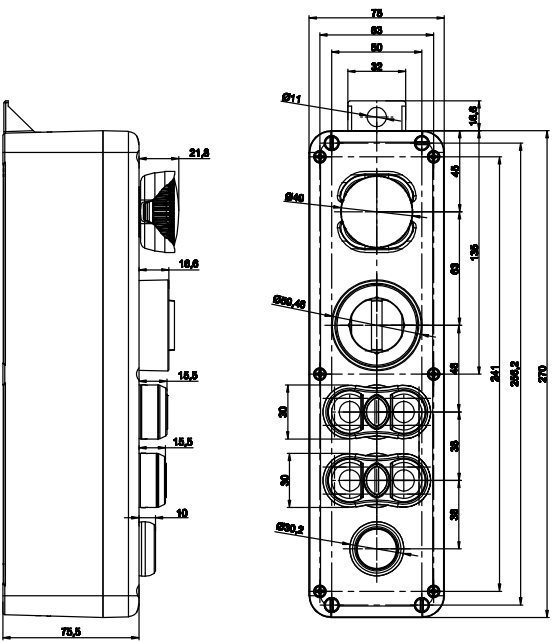



E-STOP PUSH PULL + NORMAL INSPECTION SWITCH + UP + COMMON + DOWN

E-STOP	SWITCH	UP	COMMON	DOWN	PART NUMBER
2NC	2NC+2NO	2NO	1NC+1NO	2NO	B50A001

DIMENSIONS

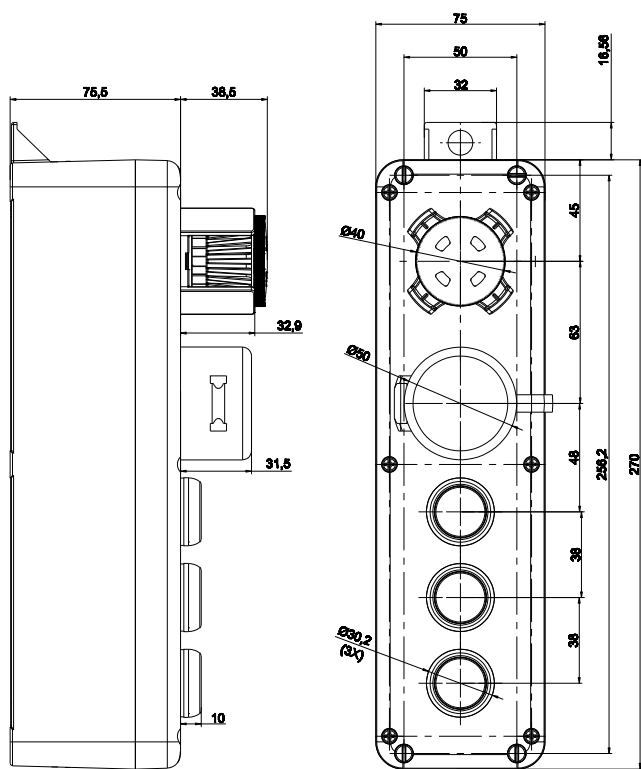

MONOLITHIC E-STOP PUSH PULL + NORMAL INSPECTION SWITCH + UP + COMMON + DOWN

E-STOP	SWITCH	UP	DOWN	ALARM	COMMON	DOOR CLOSE	DOOR OPEN	PART NUMBER
2NC	3NC+3NO	2NO	2NO	1NO	1NO	1NO	1NO	B5MA003

DIMENSIONS

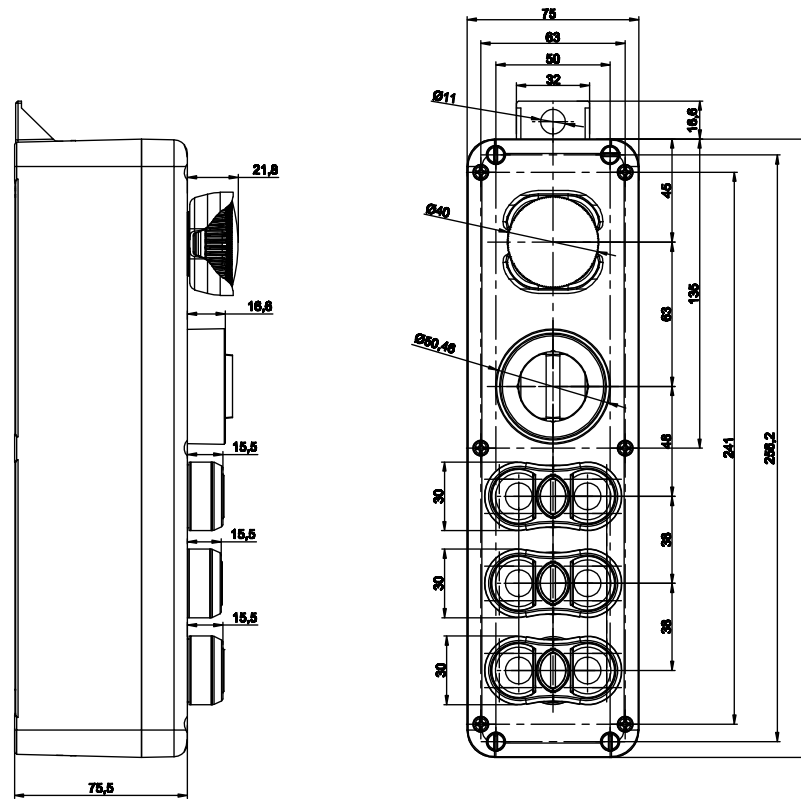

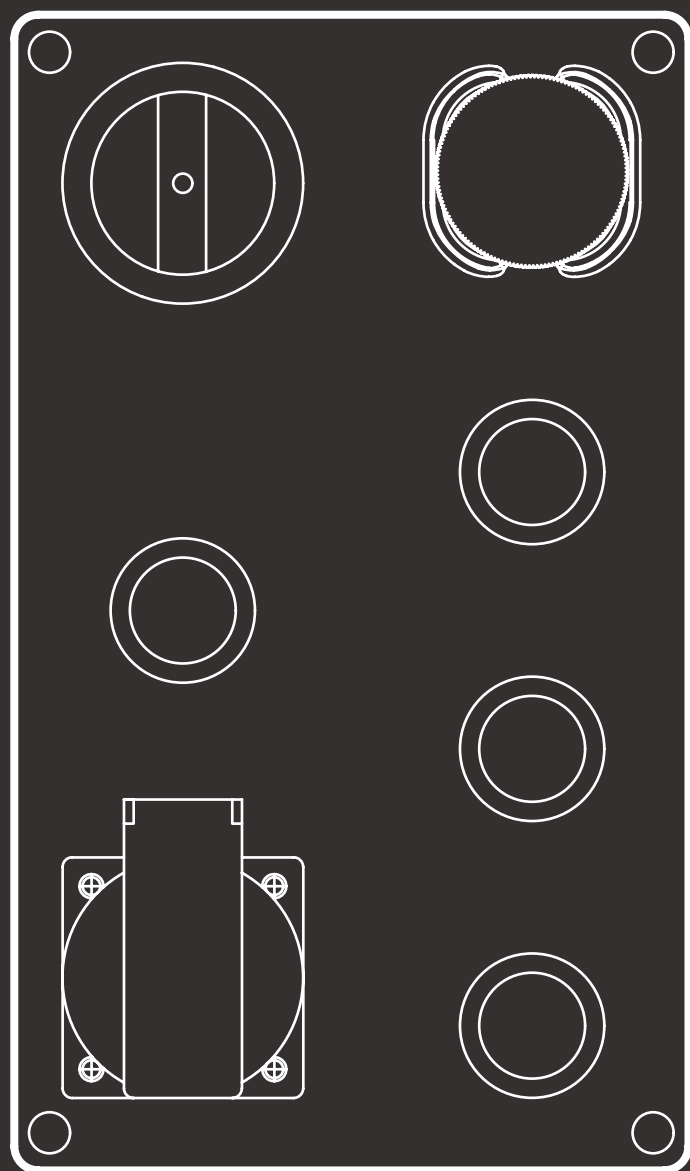

INSPECTION BOXES



E-STOP PUSH PULL + NORMAL INSPECTION SWITCH + UP + COMMON + DOWN

SWITCH	E-STOP	UP	COMMON	DOWN	SOCKET	PART NUMBER
3NC+3NO 	2NC 	2NO 	1NO+1NC 	2NO 	UNIVERSAL	B6MC001
3NC+3NO 	2NC 	2NO 	1NO+1NC 	2NO 	SCHUKO	B6MC002



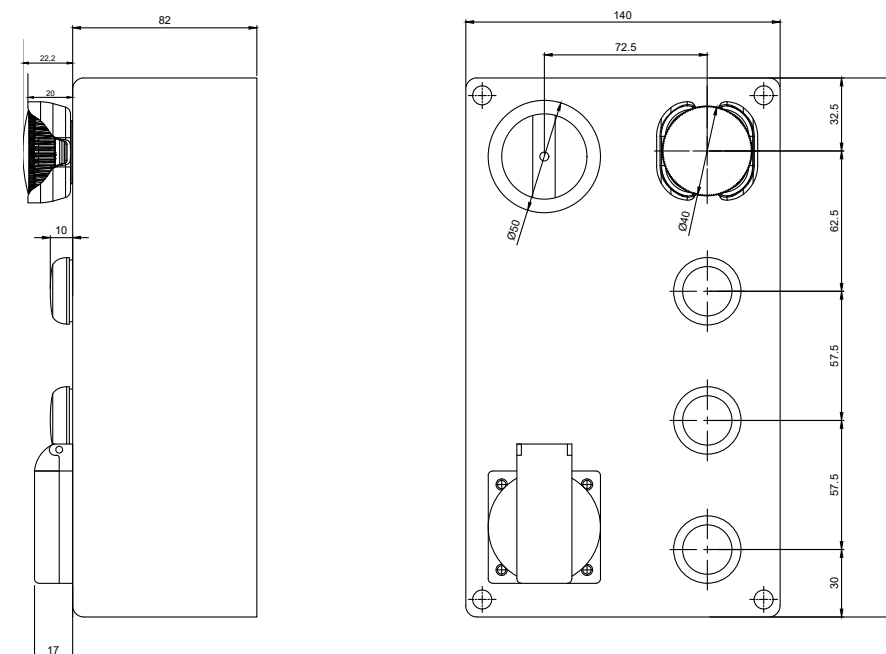



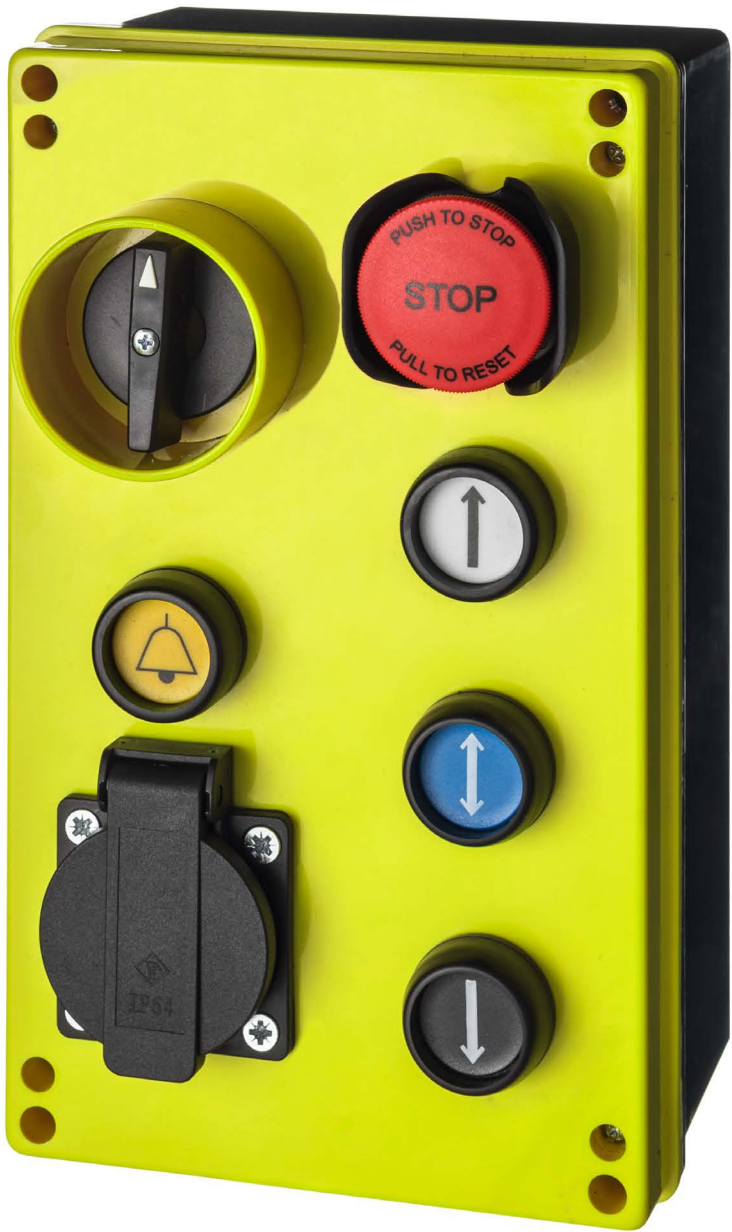

DIMENSIONS

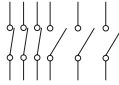
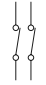



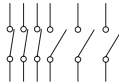
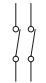

NORMAL INSPECTION SWITCH + MONOLITHIC E-STOP PUSH PULL + UP + COMMON + DOWN + ALARM + SOCKET

SWITCH	E-STOP	UP	COMMON	DOWN	ALARM	SOCKET	PART NUMBER
3NC+3NO 	2NC 	2NO 	1NO+1NC 	2NO 	LED 24V DC + 1NC	UNIVERSAL	B7MC001
3NC+3NO 	2NC 	2NO 	1NO+1NC 	2NO 	LED 24V DC + 1NC	SCHUKO	B7MC002

DIMENSIONS

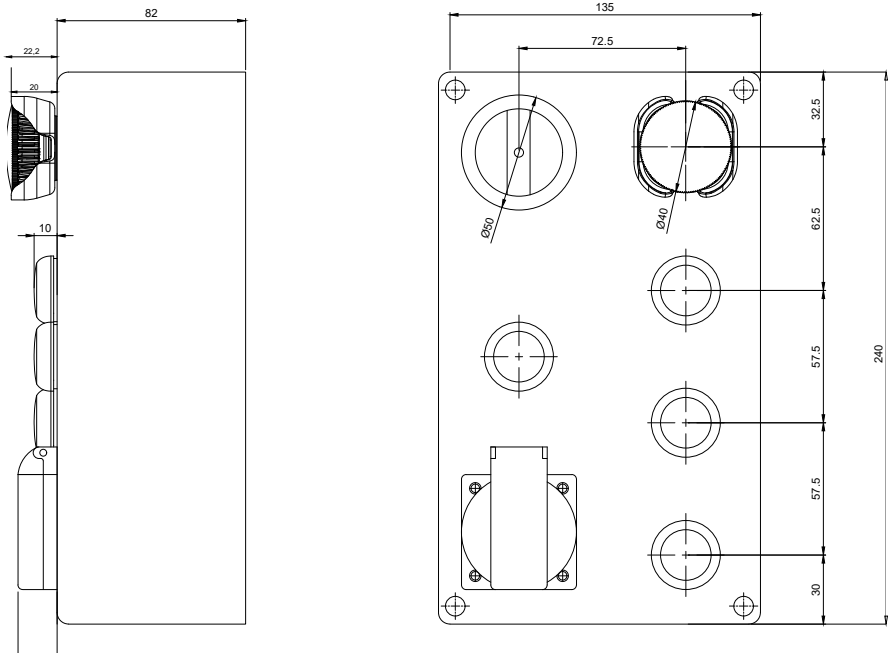

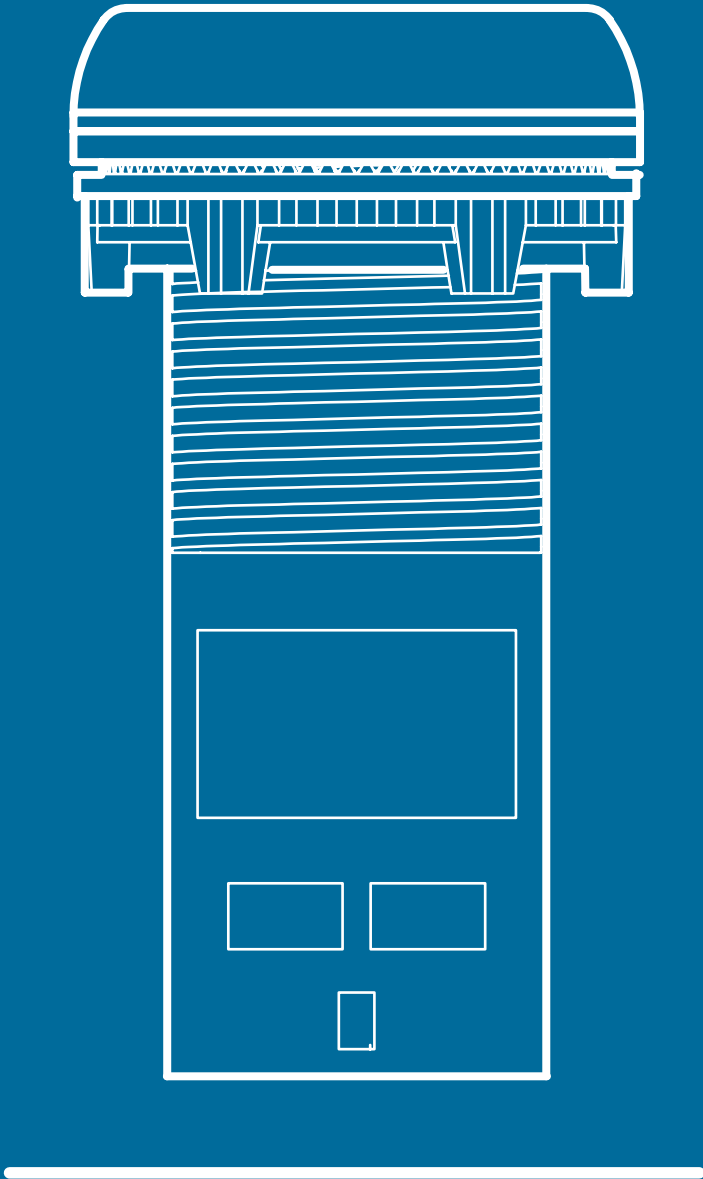









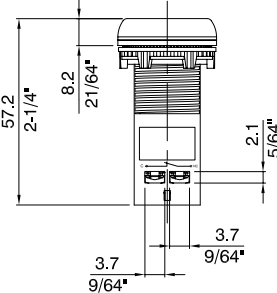

PUSH BUTTONS

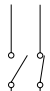
MONOLITHIC VERSION WITH PROTECTION

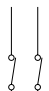







FLUSH CONTACTS INTEGRATED

COLOURS			CONTACTS					DIMENSIONS		
01		RED	1NO	1NC	1NO+1NC	2NO	2NC			
02		GREEN								
03		YELLOW	1	2	3	5	6			
04		BLUE								
05		WHITE								
06		BLACK								

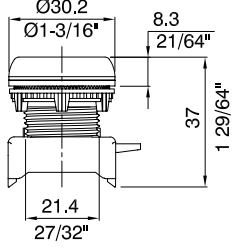
MODULAR VERSION WITH PROTECTION



FLUSH MODULAR

CONTACTS		DIMENSIONS	
01		RED	
02		GREEN	
03		YELLOW	
04		BLUE	
05		WHITE	
06		BLACK	

MONOLITHIC SELECTOR SWITCH



MODULAR SELECTOR SWITCH



CONTACTS INTEGRATED





CONTACTS	DESCRIPTION	DIMENSIONS
1NO 1NC 1NO+1NC 1NC+1NO 2NO 2NC	<div>NO SPRING RETURN</div> <div>SPRING RETURN</div> <div>NO SPRING RETURN</div> <div>SPRING RETURN</div> <div>NO SPRING RETURN</div>	

MODULAR



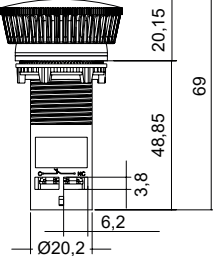

CONTACTS	DESCRIPTION	DIMENSIONS
01 RED 02 GREEN 05 WHITE 06 BLACK	<div>NO SPRING RETURN</div> <div>SPRING RETURN 30°</div> <div>NO SPRING RETURN</div> <div>SPRING RETURN</div> <div>SPRING RETURN LEFT HAND</div> <div>SPRING RETURN RIGHT HAND</div>	

MONOLITHIC EMERGENCY MUSHROOM



TWIST TO RELEASE			
COLOUR	DESCRIPTION		
 RED	1NC	1NO+1NC	2NC
			
	2	3	6
			

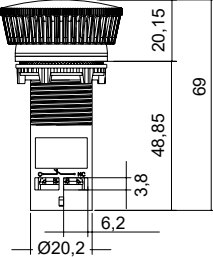

PUSH PULL			
COLOUR	DESCRIPTION		
 RED	1NC	1NO+1NC	2NC
			
	2	3	6
			

MODULAR EMERGENCY MUSHROOM

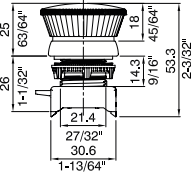

TWIST TO RELEASE	
COLOUR	DIMENSIONS
 RED	

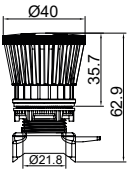

TWIST TO RELEASE VISION	
COLOUR	DIMENSIONS
 RED	

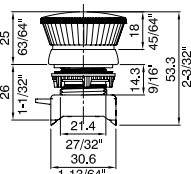

PUSH PULL	
COLOUR	DIMENSIONS
 RED	

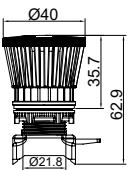

PUSH PULL VISION	
COLOUR	DIMENSIONS
 RED	



CONTACT ELEMENTS

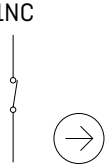
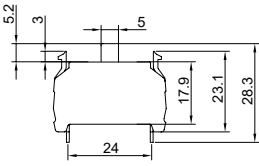

SCREW TERMINALS NC ELEMENT

COLOUR	CONTACT	DIMENSIONS
 RED	INC 	

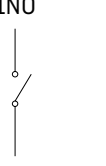
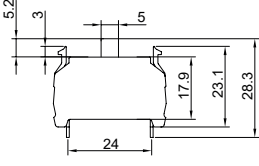

SCREW TERMINALS NO ELEMENT

COLOUR	CONTACT	DIMENSIONS
 GREEN	INO 	

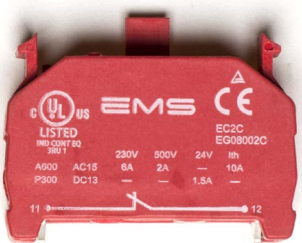

PCB BONDING TERMINALS NC ELEMENT

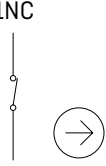
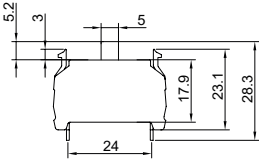
COLOUR	CONTACT	DIMENSIONS
 RED	INC 	

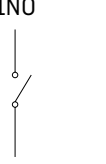
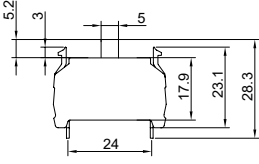

PCB BONDING TERMINALS NO ELEMENT

COLOUR	CONTACT	DIMENSIONS
 GREEN	INO 	

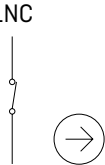
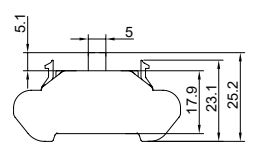

SPRING CLAMP TERMINALS NC ELEMENT

COLOUR	CONTACT	DIMENSIONS
 RED	INC 	

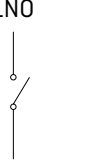
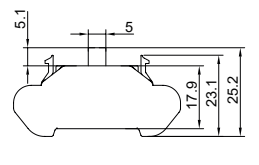

SPRING CLAMP TERMINALS NO ELEMENT

COLOUR	CONTACT	DIMENSIONS
 GREEN	INO 	



## CONTACT ELEMENTS

UTILIZATION CATEGORY	SUPPLY	IEC - 60947-5-1U	L-508I	TH/THERMAL CURRENT
	AC	AC-15	A600	10A
	DC	DC-13	P300	
Contact	NO and NC			
Rated Voltage	230V AC	120V AC	24V AC	
Rated Current	6 A	6 A	1.5 A	
Frequency	50-60 Hz			
Electrical Life for Contact	0.5 million Cycle			
HV Test for 60 Sec	2.5KV (All Terminals Shorted Together)			
Rated insulation Voltage	600 VAC			
Terminals	Suitable for flexible or solid conductors from 2x1 mm2 to 2x2.5 mm2			
Current Carrying Material	Brass			
Contact Type	Make & Break			
Contact Material	AgNi			
Insulation Resistance at 500 VDC	50 M Ø			
Operating Torque	0.8 Nm			
Contact Resistance	20 M Ø			
MV drop at 16 A DC	200 MV			
Type	Non Illuminated / Illuminated			
Function	Push, Push - Push, Push turn, Selector			

### Disposition of Contact

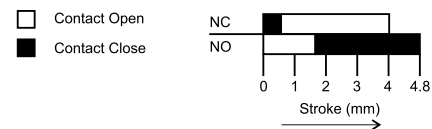

## ENVIRONMENTAL RATING

Operating Temperature	-25°C to 65°C
Storage Temperature	-30°C to 70°C
IP Rating	P65 above panel (As per IEC/EN -60529) & IP20 for Terminals NEMA 1,2,3,4,4X class 12 & 13
RoHS Compliance	Yes

## MECHANICAL LIFE FOR ACTUATORS

Momentary (Push Button with Push Function)	1 million Operation
Emergency Stop (Turn to Release)	0.1 million Operation
Emergency Stop (Push Pull Type)	0.5 million Operation
Selector	0.5 million Operation

## MONOLITHIC CONTACT



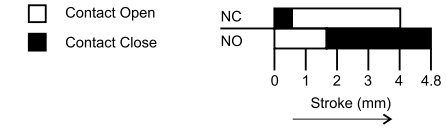

UTILIZATION CATEGORY	SUPPLY	IEC - 60947-5-1U	L-508I	TH/THERMAL CURRENT
	AC	AC-15	A600	10A
	DC	DC-13	P300	
Contact	NO and NC			
Rated Voltage	230V AC	120V AC	24V AC	
Rated Current	6 A	6 A	1.5 A	
Frequency	50-60 Hz			
Electrical Life for Contact	0.5 million Cycle			
HV Test for 60 Sec	2.5KV (All Terminals Shorted Together)			
Rated insulation Voltage	600 VAC			
Terminals	Suitable for flexible or solid conductors from 2x1 mm2 to 2x2.5 mm2			
Current Carrying Material	Brass			
Contact Type	Make & Break			
Contact Material	AgNi			
Insulation Resistance at 500 VDC	50 M Ø			
Operating Torque	0.8 Nm			
Contact Resistance	20 M Ø			
MV drop at 16 A DC	200 MV			
Type	Non Illuminated / Illuminated			
Function	Push, Push - Push, Push turn, Selector			

### Disposition of Contact



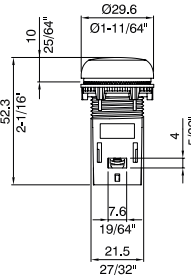





MONOLITHIC POWER LED LIGHT 20 LUMEN

COLOUR	VOLTAGE	DIMENSIONS
01  RED	24V AC/DC	
02  GREEN	48V AC/DC	
03  YELLOW	110V AC	
04  BLUE	110V DC	
05  WHITE	240V AC	
	220V DC	

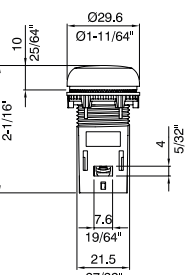

MONOLITHIC LED LIGHT INTERMITTENT 10 LUMEN

COLOUR	VOLTAGE	DIMENSIONS
01  RED	24V AC/DC	
02  GREEN	48V AC/DC	
03  YELLOW	110V AC	
04  BLUE	110V DC	
05  WHITE	240V AC	
	220V DC	

MONOLITHIC LED

PRODUCT	22.5 mm Indicators
RATED VOLTAGE	12V AC/DC
	24V AC/DC
	30V AC/DC
	48V AC/DC
	64V AC/DC
	110V AC, 110V DC
	240V AC, 220V DC
Operating Voltage	-20% to +10% of rated voltage
Type of LED	Side View SMD LED's
Available Colours	Red/Green/Yellow/Amber/Blue/White/Clear
Life	0.1 million burning hour
Operating Frequency	50 / 60 Hz
Operating Temperature	-25°C to 65°C
Storage Temperature	-30°C to 70°C
Wire Termination Capacity	0.5mm2, 1.5 - 2.5 mm2
Terminal Torque	0.8 Nm
LVGP	Available
Surge Test	2kV
HV test for 60 sec.	1.5kV
Degree of Protection	Above panel: IP65 For terminals: IP20
International Approvals	CE, UL



VOLTAGE	DIMENSIONS
12V AC/DC	<p>Ø29.6 Ø1-11/64" 64 16 5/8" 2-5/16" 19.6 Ø49/64"</p>
24V AC/DC	
30V AC/DC	
48V AC/DC	
64V AC/DC	
110V AC	
240V AC	
80dB	

PANEL MOUNTED BUZZER

PRODUCT	22.5 mm
RATED VOLTAGE	12V AC/DC
	24V AC/DC
	30V AC/DC
	48V AC/DC
	64V AC/DC
	110V AC, 110V DC
	240V AC, 220V DC
415V AC	
Operating Voltage	-20% to +10% of rated voltage
Available Colours	Black / Yellow
Life	0.1 million burning hour
Operating Frequency	50 / 60 Hz
Operating Temperature	-25°C to 65°C
Storage Temperature	-30°C to 70°C
Wire Termination Capacity	0.5mm2, 1.5 - 2.5 mm2
Terminal Torque	0.8 Nm
LVGP	Available
Surge Test	2kV
HV test for 60 sec.	1.5kV
Degree of Protection	Above panel: IP65 For terminals: IP20
International Approvals	CE, UL

DISCONNECTORS



CONTACTS CONFIGURATION

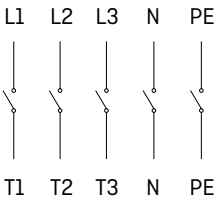

DIMENSIONS

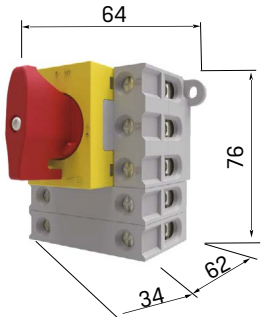

CONTACTS CONFIGURATION

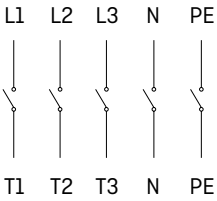

DIMENSIONS

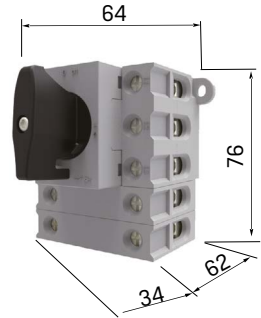

SPECIFICATIONS

MODEL	S3A63NG	
Rated insulation voltage (V)	690	
Rated carry current (A)	63	
Rated operating current (A)		
AC-23A	45	
AC-3	37	
Rated voltage (Ue)	240	440
Rated operating current (A)		
AC-23A	15	22
AC-3	11	18.5
UL-CSA	240	440
Motor load (HP)	10	20
Rated short-time withstand current (Icw)	600	
Connect wires (mm²)	1-16	
Screw Torque (N·m)	1.5-2	



CONTACTS CONFIGURATION					DIMENSIONS	
L1	L2	L3	N	PE		
T1	T2	T3	N	PE		



CONTACTS CONFIGURATION					DIMENSIONS	
L1	L2	L3	N	PE		
T1	T2	T3	N	PE		

SPECIFICATIONS		
MODEL	S3A32NG	
Rated insulation voltage (V)	690	
Rated carry current (A)	32	
Rated operating current (A)		
AC-23A	25	
AC-3	23	
Rated voltage (Ue)	240	440
Rated operating current (A)		
AC-23A	7.5	12.5
AC-3	5.5	11
UL-CSA	240	440
Motor load (HP)	51	0
Rated short-time withstand current (Icw)	400	
Connect wires (mm²)	0.5-10	
Screw Torque (N.m)	0.8-1.7	



NORMAL INSPECTION BYPASS SWITCHES



# BYPASS SWITCH STATION

## NORMAL INSPECTIONSWITCH SCHEME

## PART NUMBER

1

1	3	5	7
↓	↓	↓	↓
↑	↑	↑	↑
2	4	6	8
X		X	
	X		X

CSIB12CD1B

2

1	3	5	7	9	11
↓	↓	↓	↓	↓	↓
↑	↑	↑	↑	↑	↑
2	4	6	8	10	12
X					X
				X	
		X			
				X	

CSIB12CD2B

3

1	3	5	7
↓	↓	↓	↓
↑	↑	↑	↑
2	4	6	8
X			X
	X		
		X	X

CSIB12CD3B

4

1	3	5	7
↓	↓	↓	↓
↑	↑	↑	↑
2	4	6	8
	X		
X			
		X	
			X

CSIB12CD4B



BYPASS DIN RAIL FIXING

# NORMAL INSPECTIONSWITCH SCHEME

# PART NUMBER

1

	1	3	5	7
	↓	↓	↓	↓
	↓	↓	↓	↓
1	X		X	
0				
2		X		X

CSCB12CD1B

2

	1	3	5	7	9	11
	↓	↓	↓	↓	↓	↓
	↓	↓	↓	↓	↓	↓
0	X					X
1					X	
2			X			
3					X	X

CSCB12CD2B

3

	1	3	5	7
	↓	↓	↓	↓
	↓	↓	↓	↓
0				
1	X			X
2		X		X
3			X	X

CSCB12CD3B

4

	1	3	5	7
	↓	↓	↓	↓
	↓	↓	↓	↓
0		X		
1	X			
2			X	
3				X

CSCB12CD4B

CS Series 12/16A		
SIZE SERIES	CS12	CS16
L <sub>th</sub>	12	16
AC21	Switching of resistive loads with light overloads	
U <sub>e</sub> [V]	690	690
I <sub>e</sub> [A]	12	16
AC2	Switching of resistive loads with light overloads	
220...240V - 3ph [kW]	690	5,5
380...440V - 3ph [kW]	4,3	9,5
500V - 3ph [kW]	4,3	9,5
AC23	Switching of resistive loads with light overloads	
220...240V - 1ph [kW]	1,3	3,2
220...240V - 3ph [kW]	3,9	5,5
380...440V - 3ph [kW]	5,5	10,5
500V - 3ph [kW]	5,5	10,5
AC3	Switching of resistive loads with light overloads	
220...240V - 1ph [kW]	1,6	3,0
220...240V - 3ph [kW]	3,0	5,5
380...440V - 3ph [kW]	4,2	70,9
500V - 3ph [kW]	4,2	10,5
AC4	Switching of resistive loads with light overloads	
220...240V - 1ph [kW]	0,35	0,8
220...240V - 3ph [kW]	2,1	2,2
380...440V - 3ph [kW]	2,2	3,9
500V - 3ph [kW]	2,2	4,1
AC4	Switching of resistive loads with light overloads	
220...240V - 1ph [kW]	-	6,2
220...240V - 3ph [kW]	-	4,3
380...440V - 3ph [kW]	-	3,3

SIZE SERIES	CS12	CS16
Admittable short-time rated current	A	500
Minimum / Maximum connecting cables sections	[mm²]	6
Terminals screws	M3	M3
Mechanical life	10 <sup>6</sup>	10 <sup>6</sup>
Electrical life	5.10 <sup>5</sup>	5.10 <sup>5</sup>
Load capacity with discontinuous load	Duty cycle: 60/40/25 % = 1,3/1,6/2,0 x I <sub>th</sub>	
Operating ambient temperature	°C	free air +60...-25
Reference standards	IEC/EN 60947-3	IEC/EN 60947-3
Pending homologations	UL, CSA, IMQ	-

ELEVATOR LIMIT SWITCHES

LIMIT SWITCHES LB1



LIMIT SWITCHES LB1 SPECIFICATIONS			
MODEL			
Standards		IEC 60947-5-1 EN 60947-5-1	
Certifications - Approvals		UL-CSA-IMQ-EAC-CCC	
Air temperature near the device			
– during operation	°C	-25 ... + 70	
– for storage	°C	-30 ... + 80	
Mounting position		All position are authorised	
Protection against electrical shocks (acc. toIEC 61140)		Class II	
Degree of protection (according toIEC 60529 andEN60529)		IP 65	
ELECTRICAL DATA			
Rated insulation voltage Ui		500 V (degree of pollution 3)	
- according toIEC 60947-1 andEN60947-1		[400V for contacts type Z6, X7, X8, W9]	
- according toUL 508 andCSAC22-2 n° 14		A 600, Q 600 (A 300, Q300 for contacts type X12P, X21P, W03P)	
Rated impulse withstand voltage U <sub>imp</sub> (according toIEC 60947-1 andEN60947-1)		kV	6
Conventional free air thermal current I <sub>th</sub> (according toIEC 60947-5-1) θ < 40 °C		A	10
Short-circuit protection Up < 500 V a.c. - gG (gl) type fuses		A	10
Rated operational current			
I <sub>e</sub> / AC-15 (according to IEC 60947-5-1)	24 V - 50/60 Hz	A	10
	120 V - 50/60 Hz	A	6
	400 V - 50/60 Hz	A	4
I <sub>e</sub> / DC-13 (according to IEC 60947-5-1)	24 V - 50/60 Hz	A	6
	120 V - 50/60 Hz	A	0,55
	400 V - 50/60 Hz	A	0,4
Switching frequency		Cycles/h	3600
Load factor		0,5	
Resistance between contacts		m Ω	25
Connecting terminals		M3.5 (+,-) pozidriv 2 screw with cable clamp (M3 for 3 poles contacts type)	
Terminal for protective conductor			
Connecting capacity		1 or 2 x mm <sup>2</sup>	0.75 ... 2.5 (0.34... 1.5 for 3 poles contacts type)
Terminal marking		According to IEC 60947-5-1	
Mechanical durability		15 mlns of operations 10 mlns of operations >5 mlns of operations	T10...12; T21; T2101; T30... 34; T38 T13; T41...48; T51...55; T61... 75 T14; T35; T36; T39; T91...93; T98
Electrical durability (according to IEC 60947-5-1)		Utilization categories AC-15 andDC-13 (Loadfactor of 0.5 according tocurves below)	



LB1P\_P51

LB1P\_P41

LB1P\_13

LB1P\_P42

AC-15 SNAP ACTION

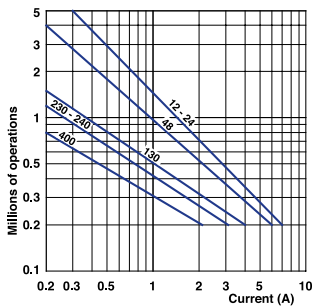

AC-15 SLOW ACTION

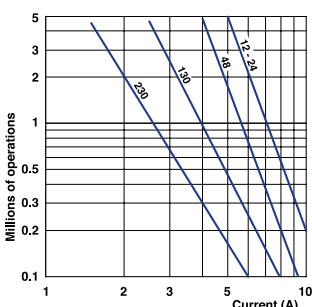

DC-13	SNAP ACTION	SLOW ACTION
Power breaking for a durability of 5 million operating cycles		
Voltage 24V	9.5 W	12 W
Voltage 48V	6.8 W	9 W
Voltage 110V	3.6 W	6 W



LIMIT SWITCHES LB4 SPECIFICATIONS						
LB4 SERIES						
Standards			IEC 60947-5-1 EN 60947-5-1			
Air temperature near the device – during operation – for storage		°C	-25 ... + 70			
		°C	-40 ... + 70			
Mounting position			All position are authorised			
Protection against electrical shocks (acc. to IEC 61140)			Class II			
Degree of protection (according to IEC 60529 and EN60529)			IP 67			
Degree of protection (according to UL50)			Type 1 enclosure (“indoor use only”)			
Switching frequency			3600			
Mechanical durability			10 millions of operations			
ELECTRICAL DATA						
Code		LB4_U	LB4_UP	LB4_HF	LB4_M	LB4_A
Cable type		4xAWG18 PVC style	4xAWG18 dynamic PUR style 20668	4xAWG18 halogen free PUR style 20668	-	-
Min. bend radius		49 mm	49 mm	49 mm	-	-
Rated insulation voltage U <sub>i</sub>		400V	300V	300V	250V	250V
Rated impulse withstand voltage U <sub>imp</sub>		4kV	4kV	4kV	2.5kV	2.5kV
Conventional free air thermal current I <sub>th</sub>		10A	10A	10A	4A	4A
Short-circuit protection		10A 500V type gG	10A 500V type gG	10A 500V type gG	4A 500V type gG	4A 500V type gG
AC15	24V	10A	10A	10A	4A	4A
	120V	6A	6A	6A	4A	4A
	240V	3A	3A	3A	3A	3A
AC15	24V	2.8A	2.8A	2.8A	2.8A	2.8A
	125V	0.55A	0.55A	0.55A	0.55A	0.55A
	250V	0.27A	0.27A	0.27A	0.27A	0.27A
Approvals		cULus EAC CCC	cULus EAC	cULus EAC	cULus IMQ EAC CCC	EAC

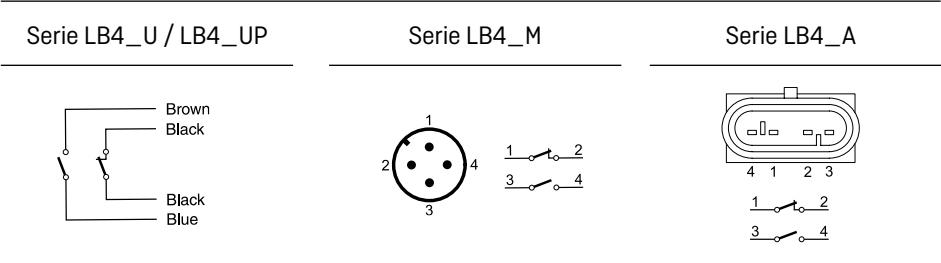

LB4P\_G42



LB4P\_G5100



LB4P\_G41



300 Roundhill Drive Unit 4  
Rockaway, NJ 07866 Tel:  
973-586-2500  
[www.norstat.com](http://www.norstat.com)